

XENIA FOUNDRY At A Glance

Gray and Ductile Iron Castings

Gray Iron
Class 30
Wt: 19-lbs.



Ductile Iron
Grade 65-45-12
Wt: 78-lbs.



Gray Iron
Class 30
Wt: 101-lbs.



Gray Iron
Class 35
Wt: 28-lbs.



Gray Iron
Class 30
Wt: 48-lbs.



Ductile Iron
Grade 80-55-06
Wt: 80-lbs.

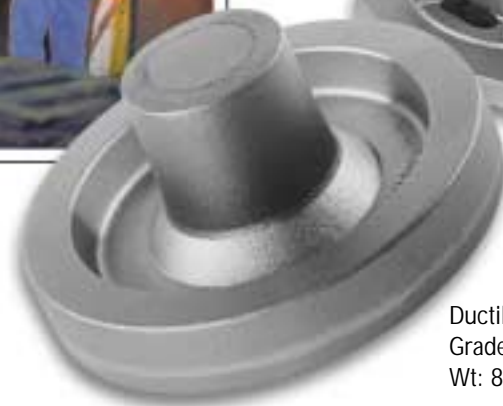

XENIA

FOUNDRY AND MACHINE COMPANY

252 North West Street
P.O. Box 397, Xenia, Ohio 45385
Tel 937-372-4481 Fax 937-372-8335

www.xeniafoundry.com

Quality Iron Castings since 1920

- Size Range: 1 to 350 pounds
- Quantity Range: 1 to 1000 pieces
- Prototypes/Small Custom Orders
- Specialists in Converting Steel Weldments to Iron Castings
- Long-term Customer Partnerships
- Continuous Quality Improvement
- Concurrent Engineering

*Committed to 100%
On-Time Delivery*